

HUT OF HOPE ASSEMBLY INSTRUCTIONS

STEP BY STEP:

1. Using a sharp knife cut a potato chip can in half. The cutting should be done ahead of time, not by the children.
2. Cut, wrap and glue the burlap around the can and set aside to dry. (The thicker the glue, the easier the gluing!) Glue in baby food jars is good for the children. Put a small amount in each jar. When the craft session is over, be sure to wipe the tops of the jars to prevent sealing on the lids.
3. Paint a mud brick pattern and a door on the burlap or paper with black marker.
4. Cut out the cardboard roof supports from the pattern provided. Connect at center joint. Glue at joint.
5. Cut the roof from heavy paper using the pattern provided. Glue side A to side B.
6. Glue straw or grass (or whatever you can find to make the thatch) to the roof. Place roof support on top of can. Glue the slanted edges of the roof support to attach the roof.
7. Set aside to dry.

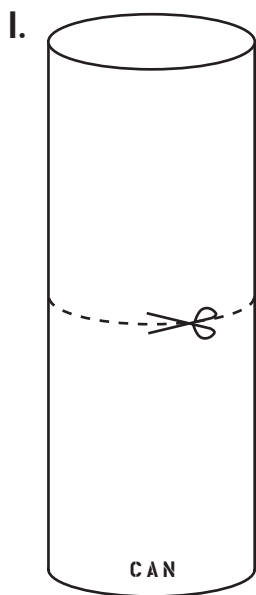

2. & 3.

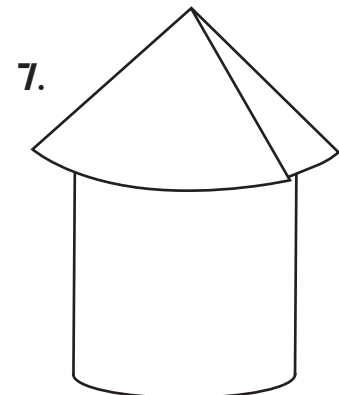
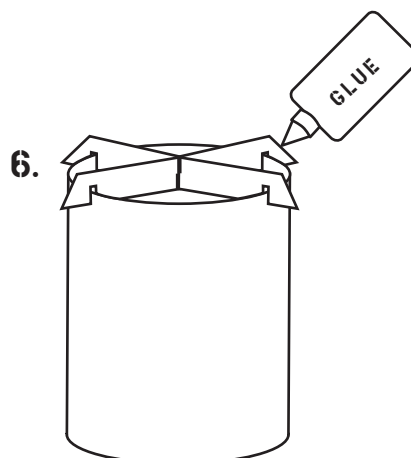
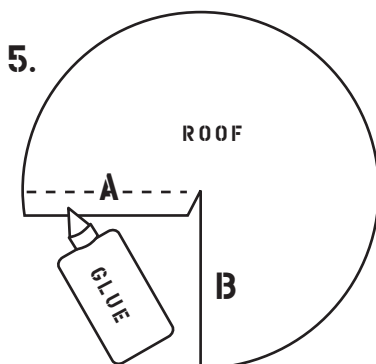
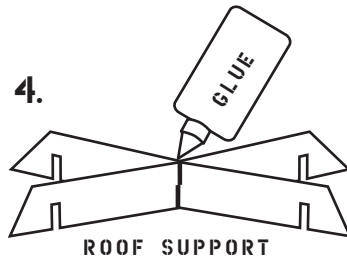
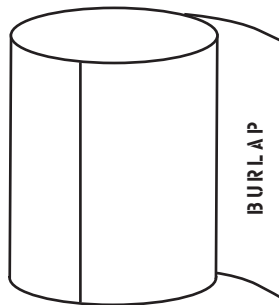

HUT OF HOPE TEMPLATES

